

CB 374

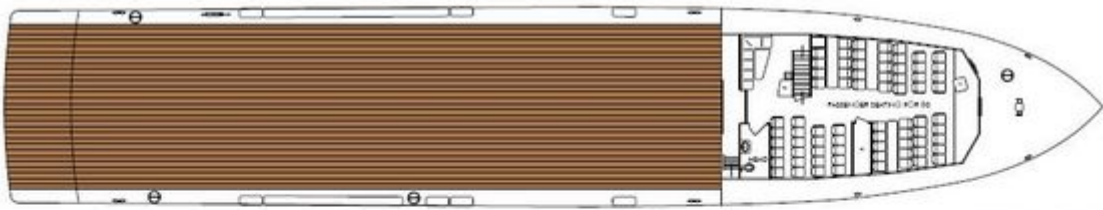

MAIN DECK

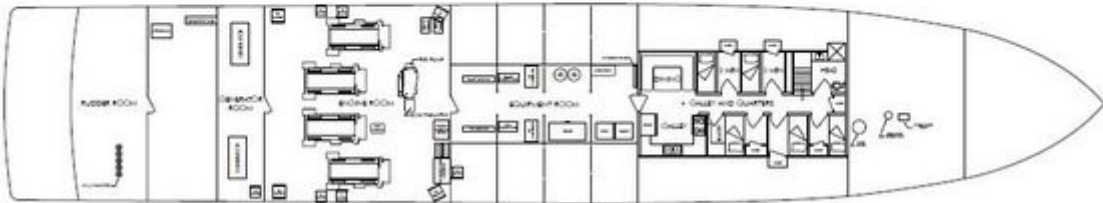

ABOVE TANK TOP

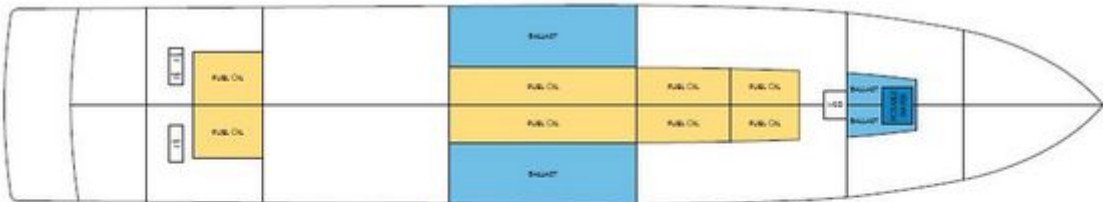

BELOW TANK TOP



P.O. Box 1186, Patterson, La. 70392 | 115 Landry St., Patterson, La
Phone: 985-399-7222 | Fax: 985-395-3525 | office@leefeltman.com

Asking Price: \$4,000,000.
Size: 170' x 30' x 12.6'.
Type: Aluminum Crew boat DP-2.
ABS: Classed AMS, A1, DP-2.
Year Built: 2005.
Certifications: USCG Certified.
Flag: USA.
Max Draft: 9'
Max Speed: 26 knots
Passengers: 80

Galley: Complete
A/C & Heat: Central
Fuel Capacity: 23,600 gallons
Water Capacity: 36,000 gallons
Deck Space: 108' x 26'
Deck Cargo: 285 Long tons
Main Engines: (4) – CAT 3512B 6,700BHP
Bow Thruster: (2) – 200hp Tunnel
Generator: (2) – 80 KW
Electronics: (4) VHF, SSB, (2) Radar, AIS, DS, Sarts, GPS, Autopilot
Fire Monitor: yes
Location: Gulf of Mexico USA
Comments: ABS CLASSED & DP-2

DISCLAIMER: Vessel description is believed to be correct, but not guaranteed. Price Subject to change without notice.
Subject to prior sale or charter.